

Our facilities were designed by Steve Durr and Matt Schlachter and include main lounge/control/creation room and a large comfortable booth. Main monitors were designed by Steve Durr and constructed by Travis Smith, with components from Altec, TAD and Bag End. Main monitor signal chain by Mike Schatzlein and Jake Saghi, with Trinnov crossover and amps from Hafler, CLA and Crown. The main monitors are custom built modifications of the Altec "Voice of the Theater" design, with Altec 515 woofers and 511 horns with TAD-2002 drivers. Bag End ELF subwoofer processor with D12E subwoofer. Focal Trio6Be and Yamaha NS-10M nearfields. MTRX and DAD-Man monitor and cue routing.

Control Surface/Converters

Avid System 6 M40-32-9-D with 32 faders, display modules and 9 knobs per channel. Burl Mothership HDX with 32 I/O channels. Avid MTRX with 16 channels of DAD converters.

Tape

Studer A827 24-track (< 5000 hours, reconditioned by Steve Smith)
Studer A807 Mark II 2-track (reconditioned by Dr. Reinhardt Schwäbe and Jake Saghi)
16 channels of Dolby A/SR

Microphones

<u>Condenser</u>		<u>Ribbon</u>	
AKG C414B	(2)	Cloud 44A	
AKG C451B	(2)	RCA 77-DX (Vintage)	
Audio-Technica AT4033/CL	(2)	Rode NTR	
Beyerdynamic MC930	(2)	Se RNR1	(2)
Blue Kiwi	(2)	sE VooDoo VR2	(2)
Miktek CV4 Tube	(2)		
Neumann KM185	(2)	<u>Dynamic</u>	
Neumann M149 Tube			
Neumann U87ai	(2)	AKG D12 VR kick drum	
sE sE4400a	(2)	Sennheiser e609 Silver	(2)
		Shure SM57	(5)
		Shure Beta91A kick drum	(2)

Instruments and Amps

Yamaha Montage M6
Kurzweil 2600 with 88 weighted keys
Martin DXM six-string
Paiste crash and ride cymbals
Roland V-drums with mesh heads
Roland TD-50 sound module

Fender Twin Reverb (65 reissue)
Fender Mustang
Gibson Les Paul Studio 70s Tribute
Gibson Les Paul Melody Maker
Jamstik Studio MIDI guitar

Mic Preamps and Channels

Avalon VT-737sp
Cloudlifter CL-1 (2)
LaChappell tube (2)
Rupert Neve Portico II (2)
Soyuz Analog Launcher
Trident 80B (2)
Universal Audio 6176
Focusrite Scarlett (8)

Other Analog

MXR Bass DI+ Pedal
Line 6 Helix
Rupert Neve Master Bus Compressor
Many types of DI boxes
Many types of guitar pedals

Plugins

Hundreds from Avid, Universal Audio, Waves, SSL, Antares, Celemony, Eventide, Focusrite, FabFilter, Izotope, Oeksound, HOFA, Native Instruments, Plugin Alliance, Vir2, Softube, Eiosis, SoundToys, Slate, Sonnox, Nugen, Synchro Arts, Eosis, Audio Ease, Empirical Labs, Sound Radix, Kit, Joey Sturgis, Relab, Wave Arts, PSP, Soundtoys, Flux, Softtube, others.

Hardware DSP

Avid HDX
UAD-2 Shark Octo

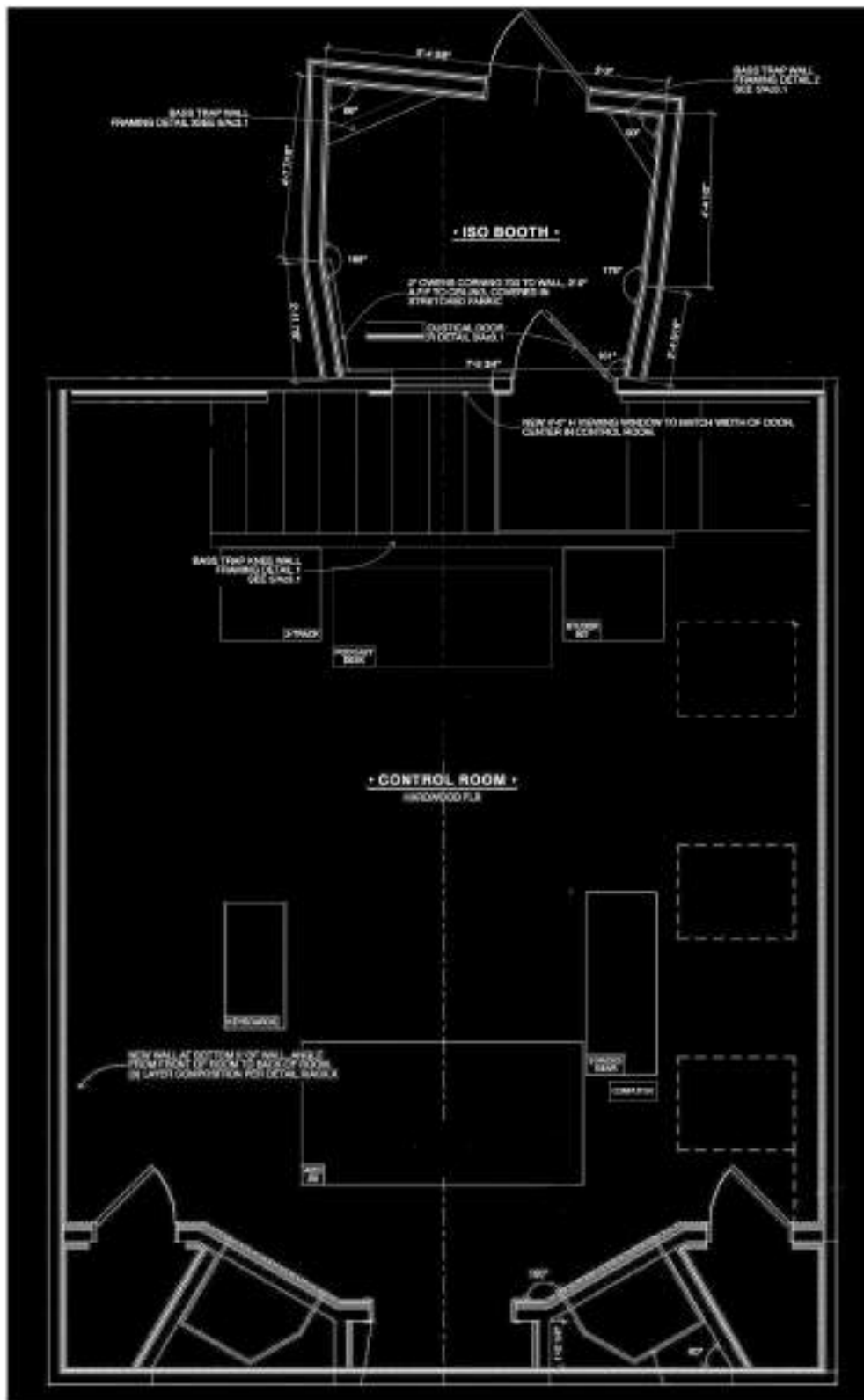

Acoustic Design
& Consultants

4117 Hillboro Pike
Suite 103-147
Nashville, TN 37215
615-383-1588

steven durr designs

CONSULTING - SOUND REPRODUCTION - ROOM ACoustics - STUDIO DESIGN - ROOM CONSTRUCTION

TRC STUDIOS
NASHVILLE

TRC Studio Five
Frequency and Phase Curves
Before and After Tuning
(Note Minimal Frequency Adjustment Needed)
(Note Phase Correction at Crossover Points)

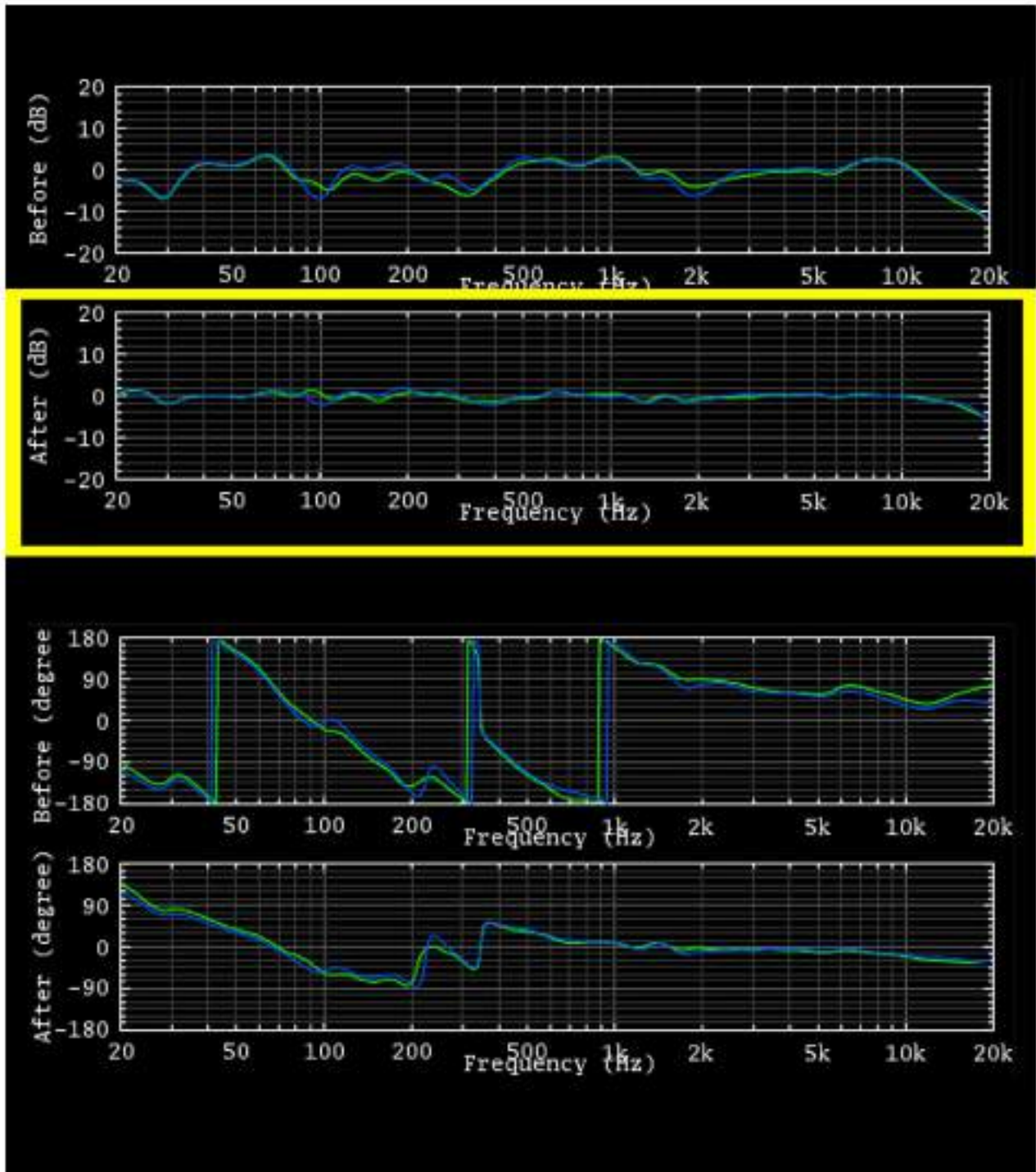

Studio Five Patchbay Map 2024

BOOTH								RACK				CONTROL ROOM								STUDER OUT								STUDER OUT								STUDER OUT																			
1	2	3	4	5	6	7	8	9	10	11	12	3	4	5	6	7	8	1	2	3	4	5	6	7	8	9	10	11	12	13	14	15	16	17	18	19	20	21	22	23	24														
PREAMP IN								SCARLETT IN								SWITCHER IN B								SWITCHER IN B								SWITCHER IN B																							
AVAL	6176P	PORT1	PORT2	80B1	80B2	LC1	LC2	3	4	5	6	7	8	1	2	3	4	5	6	7	8	9	10	11	12	13	14	15	16	17	18	19	20	21	22	23	24																		
PREAMP OUT								SCARLETT OUT								2-TRK OUT		80B INS SND		6176 PRE		363 OUT		TB																															
AVAL	6176C	PORT1	PORT2	80B1	80B2	LC1	LC2	1	2	3	4	5	6	7	8	L	R	1	2	OUT	1	2	OUT																																
SWITCHER IN A								SWITCHER IN A								SWITCHER IN A								80B INS RTN		6176 COMP		363 IN		TB																									
1	2	3	4	5	6	7	8	9	10	11	12	13	14	15	16	17	18	19	20	21	22	23	24	1	2	IN	1	2	IN																										
SWITCHER OUT								SWITCHER OUT								SWITCHER OUT								MNTG OUT		KURZ OUT		HELIX OUT		MBP OUT		DOLBY RACK OUT																							
1	2	3	4	5	6	7	8	9	10	11	12	13	14	15	16	17	18	19	20	21	22	23	24	L	R	L	R	L	R	L	R	1	2	3	4	5	6	7	8	9	10	11	12												
BURL IN								BURL IN								BURL IN								BURL IN								MTRX IN								MTRX IN															
1	2	3	4	5	6	7	8	9	10	11	12	13	14	15	16	17	18	19	20	21	22	23	24	25	26	27	28	29	30	31	32	1	2	3	4	5	6	7	8	9	10	11	12	13	14	15	16								
BURL OUT								BURL OUT								BURL OUT								BURL OUT								MTRX OUT								MULT 1				MULT 2											
1	2	3	4	5	6	7	8	9	10	11	12	13	14	15	16	17	18	19	20	21	22	23	24	25	26	27	28	29	30	31	32	17	18	19	20	21	22	23	24																
STUDER IN								STUDER IN								STUDER IN								DOLBY RACK IN				2-TRK IN		MBP IN		DOLBY RACK IN								PH REV		PH REV		PH REV		PH REV									
1	2	3	4	5	6	7	8	9	10	11	12	13	14	15	16	17	18	19	20	21	22	23	24	9	10	11	12	L	R	L	R	1	2	3	4	5	6	7	8	IN	OUT	IN	OUT	IN	OUT	IN	OUT								